

10TH - 12TH SEPT



BSLM 2026

WARWICK
ARTS
CENTRE

WARWICK ARTS CENTRE

WARWICK
CONFERENCES

ANNUAL CONFERENCE

**SPONSORSHIP
OPPORTUNITIES**

WELCOME MESSAGE

FROM
**OUR
EXECUTIVE
DIRECTOR**

DR
FRASER
QUIN



Welcome to BSLM 2026 and the wonderful Warwick University campus.

We are delighted to have you continue to support BSLM and the expansion of Lifestyle Medicine. As a charity, your support is invaluable in delivering a world class experience for our members, and we hope this is as fulfilling and productive for you, as our valued partners.

Our dedicated staff team will ensure that you have full access to a unique audience and engage with over a thousand delegates. This will allow you to promote your brand through a variety of means throughout the conference.

Please speak to your Relationship Manager, Emma Martin, to discuss options for sponsorship, exhibiting, or creating a bespoke package to maximise your impact at conference.

We look forward to welcoming you in September.



ABOUT

THE CHARITY

Lifestyle Medicine is evidence-based, clinical care that supports behaviour change through person-centered techniques to improve mental wellbeing, social connection, healthy eating, physical activity, sleep and minimisation of harmful substances and behaviours.

The British Society of Lifestyle Medicine (BSLM), is an independent charity, set up to promote the role of lifestyle medicine in improving people's health and wellbeing. Join our vast membership from primary and secondary care clinicians, allied and public health professionals, scientists, educators, researchers and patients. BSLM aims to represent you and create a community of likeminded individuals that believe Lifestyle Medicine is the future.

Want to find out more? Our visions, values and other crucial information is on our website, do check it out via the QR code, or on our website, below!



WWW.BSLM.ORG.UK

THE CONFERENCE

We can't wait to welcome you to the University of Warwick!

Join us and be part of something special, as BSLM 2026 promises to be our biggest event yet, celebrating over three days the journey of life through a Lifestyle Medicine prism. Our annual conference is the highlight of our year, bringing together many like-minded people from across the UK and the world for a comprehensive Lifestyle Medicine-based agenda. We wouldn't expect it to be any other way.

This year our conference will take place at the Arts Centre, on the stunning campus of the University of Warwick. We're excited to invite you to join us in this beautiful new setting.

Our conference is truly like no other. Not only will there be ground-breaking research in Lifestyle Medicine focusing on chronic conditions and day-to-day health, but also activities such as yoga to start the day with calm, and food that will truly nourish the soul.

We suggest you bring your exercise gear and something comfy for your feet for this jam-packed conference experience, set in 700 acres of beautiful countryside.



BSLM2026



10th, 11th and 12th
September 2026



BSLM
2026
PAGE
HERE



Warwick Arts Centre,
University of Warwick, Coventry



MAP
AVAILABLE
HERE

Our annual conference is something to be proud of, with a growing membership and higher attendance year on year.

Our venue this year will take place at the Arts Centre, on the stunning campus of the University of Warwick. We're excited to invite you to join us in this beautiful new setting as we think it's an ideal setting for high-profile events. We know this is the perfect place to host our speakers, delegates and your brand.

LOCATION AMENITIES



FOOD

We will be providing catered food throughout the event. Warwick Conferences already boasts impressive food credentials as its team of chefs also includes award-winning Chef De Partie, David Webb, who was crowned the 2022 UK Conference Chef of the Year. They work with all suppliers to purchase food sustainably. All meat procured, for example, is from farms satisfying UK Animal Welfare standards.

FACILITIES

Accessible toilets are available on the ground floor on the Butterworth Hall concourse and ambulant facilities are available in the main toilets by the Theatre. Additional accessible toilets on the ground floor and first floor, plus a [Changing Place](#) as part of the 20:20 Project. While gender-neutral toilets are not available, accessible toilets are provided. These can also be used as a gender-neutral option if needed.

PARKING AND TRANSPORT

You will need to pre-register your vehicle for complimentary parking, the details and promo code are available. If you require further information do contact us at this time. There is also further accessible parking information below within the accessibility page on Warwick Arts Centre website.

ACCESSIBILITY



PLEASE VISIT
OUR
[BSLM2026
FAQS PAGE!](#)

PRIOR VISIT

If you'd like to visit the venue before the event you're more than welcome. This can be organised directly with the venue, or alternatively contact us, and we can support this for you.

FACILITIES

Warwick Arts Centre have a limited number of wheelchairs WHICH are available for customers' use. If you need to use a wheelchair, please contact us or The Box Office direct in advance so we can reserve this for you. They have this fantastic page on their website [here](#) which gives you a breakdown of each room and have created these [venue access guides](#) in which you may find useful.

Guests requiring accessibility support will need to complete the PEEP (Personal Emergency Evacuation Plan) form so that appropriate arrangements can be made.



MORE
INFORMATION ON
[ACCESSIBILITY HERE](#)

A SNAPSHOT: THE VENUE

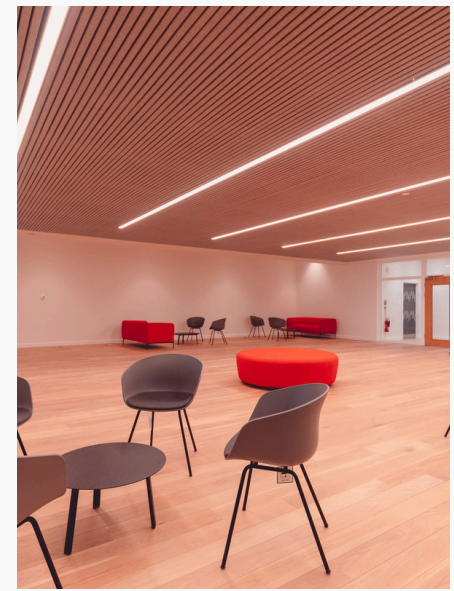



EXHIBITOR & SPONSORSHIP OPPORTUNITIES

The British Society of Lifestyle Medicine offers a range of exhibiting and sponsorship opportunities for our annual conference, BSLM2026, which will provide your organisation with exposure to an enthusiastic and like-minded audience.

If you wish to enquire about exhibiting and sponsorship and have specific questions, please don't hesitate to contact Emma Martin, your Relationship Manager, and she'll be happy to assist.



EMMA.MARTIN@BSLM.ORG.UK

VENUE DETAILS



FOR POSTAGE
Warwick Conferences
Rootes Building
University of Warwick
Coventry
CV4 7AL

<https://www.warwickartscentre.co.uk/>

Setup:

Wed 9th Sept

16:00-19:00

Thurs 10th Sept

Before 07:30, to be set up by 07:30 .

Registration open at 6:30am

Breakdown:

Sat 12th Sept

12:30pm onwards



**PLEASE VISIT
OUR
BSLM2026
FAQS PAGE!**

WHEN ARRIVING



- Access for the Arts Centre Gallery, Theatre and Studio is located at the rear of Warwick Arts Centre and is accessible directly from Gibbet Hill Road via the Arts Centre Service Road
- Gallery and Studio spaces are located on the ground floor of the building and Theatre is on the first floor
- Please note that trolleys are not provided by the venue.
- If you have a large / tall vehicle you will need to arrange in advance for suitable parking on campus by letting us know so we can notify the venue.



WE WILL, AS THE TIME CLOSES IN AROUND THE EVENT, RECEIVE FURTHER INFORMATION REGARDING EXHIBITING. IF YOU ARE INTERESTED IN UTILISING FOR SPONSORSHIP OPPORTUNITIES, WE WILL KEEP YOU REGULARLY INFORMED AS THESE COME THROUGH.

EXHIBITOR & SPONSORSHIP OPPORTUNITIES



STAND ACCESSORIES

The below is included in the exhibitor's fee:

- **Wifi**
- **Power**

For further information on table and chairs refer to pricing structure. Sizing queries can be answered on discussion.

Similar image of the table for reference



INTERNET

- The Wi-Fi service 'Warwick Guest' is free of charge and provides conference delegates/exhibitors with the freedom to use mobile (laptop or handheld) devices to connect to the University network, more details can be found [here](https://warwick.ac.uk/services/its/servicessupport/networkservices/wifi/warwick-guest): <https://warwick.ac.uk/services/its/servicessupport/networkservices/wifi/warwick-guest>
- If you require hard wired internet connection, please contact us and we will discuss.

DELIVERIES & COLLECTIONS

- The courier is responsible for delivering the parcels/items to the delivery location. Roadside deliveries will not be accepted. The courier is responsible for unloading their own vehicle, Warwick Conference are not able to assist in unloading vehicles. The courier must provide their own trolley/pallet truck according to the volume of items being delivered. Items must not be sent more than one week prior to the event without prior discussion and approval with your Event Manager. More information to follow in discussion.
- Couriers often subcontract collections which are forwarded to a central distribution point prior to being forwarded to their final delivery address. The current collection/delivery process is often completed using a booking reference number rather than a destination address, so it is important to ensure items are labelled with as much information as possible. Parcels that are left with Warwick Conferences to be collected by a courier must be clearly labelled and securely packaged. More information to follow in discussion.

PAT TESTING

- There is power at your stand. The venue requires that all exhibitors provide their own extension leads with evidence of current PAT testing certificates for any electrical equipment brought onsite. For any equipment, that is less than a year old and doesn't require PAT testing, evidence of its purchase date is required.



PLEASE NOTE SAMPLE INFORMATION

Please get in touch with us if you wish to provide samples on the day. We also request that you please be mindful to keep in line with the principles of Lifestyle Medicine any products on stand should be healthy and minimally processed items. Where an exhibitor would like to provide any form of food or drink provision on their exhibition stand (including wrapped chocolates or sweets), please be aware of conference attendees with allergies and intolerances.



AVAILABLE PACKAGES

The British Society of Lifestyle Medicine welcomes sponsorship from Organisations aligned to our aims, and in line with strict ethical and sponsorship policies. Sponsorship is open to companies, organisations, practices and similar groups supporting BSLM's aims and objectives, and shared benefit from partnering for aligned vision and goals, as well as getting their brand out to over 3000 medical and healthcare professionals. The products and services promoted are those that will benefit and be of value to our Members.

***Please refer to 'Extra Stand Tickets' on the Tailor Your Package page for more information on purchasing additional exhibitor tickets.**

CHARITY STAND

£ 1,200

STAND

ONE 6FT TABLE
X 1 CHAIRS

FEATURES

LOGO ON PROGRAMME
MATERIAL

VIRTUAL PRESENCE,
EVENT APP

EVENT APP LEAD
RETRIEVAL APP AND
LISTING

ACKNOWLEDGEMENT ON
THANK YOU SLIDE FOR
SPONSORS

1X EXHIBITOR PASSES
PER DAY TO MANAGE
STAND*

BRONZE STAND

£ 2,950

STAND

ONE 6FT TABLE
X 2 CHAIRS

FEATURES

LOGO ON PROGRAMME
MATERIAL

VIRTUAL PRESENCE,
EVENT APP

EVENT APP LEAD
RETRIEVAL APP AND
LISTING

ACKNOWLEDGEMENT ON
THANK YOU SLIDE FOR
SPONSORS

2X EXHIBITOR PASSES
PER DAY TO MANAGE
STAND*

SILVER STAND

£ 4,250

STAND

TWO 6FT TABLE
X 2 CHAIRS

FEATURES

FAVOURABLE
POSITIONING OF STAND

LOGO ON PROGRAMME
MATERIAL

VIRTUAL PRESENCE,
EVENT APP

EVENT APP LEAD
RETRIEVAL APP AND
LISTING

ACKNOWLEDGEMENT ON
THANK YOU SLIDE FOR
SPONSORS

4X EXHIBITOR PASSES
PER DAY TO MANAGE
STAND*

25% OFF ADDITIONAL
CONFERENCE TICKETS

25% OFF ON EVENING
EVENT TICKETS

GOLD HEADLINE SPONSOR

£ 10,000+

STAND

TWO 6FT TRESTLE
TABLE X 2 CHAIRS

FEATURES

NAMING RIGHTS

FAVOURABLE
POSITIONING OF STAND

LOGO ON PROGRAMME
MATERIAL

VIRTUAL PRESENCE, EVENT
APP

EVENT APP LEAD RETRIEVAL
APP AND LISTING

ACKNOWLEDGEMENT ON
THANK YOU SLIDE FOR
SPONSORS

5X EXHIBITOR PASSES PER
DAY TO MANAGE STAND*

25% OFF ADDITIONAL
CONFERENCE TICKETS

2X EVENING EVENT TICKETS
& 25% OFF ADDITIONAL
EVENING EVENT TICKETS

ACKNOWLEDGEMENT OF
SPONSORSHIP AT EVENING
EVENT

PRE OR POST EVENT
DEDICATED MAILER TO ALL
ATTENDEES

ONE YEAR FREE OF BRONZE
ORG MEMBERSHIP

PRIVATE MEETING SPACE





COMPARE TIERS



	CHARITY STAND	BRONZE STAND	SILVER STAND	GOLD HEADLINE
ONE TABLE AND BANNERS WITHIN SPACE: EXHIBITING DETAILS TBC	✓	✓		
TWO TABLES AND BANNERS WITHIN SPACE: EXHIBITING DETAILS TBC			✓	✓
VIRTUAL PRESENCE, EVENT APP	✓	✓	✓	✓
LOGO ON PROGRAMME MATERIAL	✓	✓	✓	✓
EVENT APP LEAD RETRIEVAL APP AND LISTING	✓	✓	✓	✓
ACKNOWLEDGEMENT ON THANK YOU SLIDE FOR SPONSORS	✓	✓	✓	✓
NO. OF EXHIBITOR TICKETS*	1	2	4	5
25% OFF ADDITIONAL CONFERENCE TICKETS			✓	✓
NO. OF EVENING EVENT TICKETS				2
ACKNOWLEDGEMENT OF SPONSORSHIP AT EVENING EVENT				✓
PRE OR POST EVENT DEDICATED MAILER TO ALL ATTENDEES				✓
ONE YEAR FREE OF BRONZE ORG MEMBERSHIP				✓
NAMING RIGHTS				✓



TAILOR YOUR PACKAGE BSLM 2026

Put your business/services directly in front of our attendees with the opportunity to have a promotional flyer/item added to our conference goody bags. All items must be agreed by BSLM in advance; this is available at **£350 for members and £500 for non-members**.

**PROMOTIONAL
FLYER /
ITEM
INSERT**

A limited space within the Exhibitor area will be ring-fenced for book signing. There is no cost for this but is on a first come, first serve basis, with preference given to BSLM2026 Speakers, Trailblazers & Members, and all books/authors must be agreed by BSLM in advance of the event.

**BOOK
SIGNING**

Symposiums rooms are restricted at this years' venue and therefore the number of symposium sessions will be limited. Promotional sessions, requested by Sponsors/Exhibitors. Prices from £375 (£275 for charities), further information available on the symposium packages page.

**PROMOTIONAL
SYMPOSIUM
SESSIONS**

Extra exhibitor passes can be **purchased at £325 for one or £450 for two**.

**EXTRA
STAND
TICKETS**

We are delighted to offer an exclusive new opportunity to sponsor our badge kiosks and our badges. These options include a sponsored decal printed feature, sponsor feature on the ticket kiosk screen and reverse badge sponsorship. **Please contact emma.martin@bslm.org.uk for pricing details.**

**KIOSK
AND BADGE
SPONSOR
OPPORTUNITY**

Where appropriate, sponsorship and other services may be fulfilled by WLMES Ltd. Where this is the case then VAT may be levied, at the prevailing rate.

Organisations may be approached to offer in-conference activities in line with the pillars and skills of Lifestyle Medicine. These are not charged for, are focused on education, rather than promotion of the facilitator or their related organisation. These will be requested by the BSLM conference steering team only.

Should you be interested in exhibiting or sponsoring BSLM 2026, please respond via the digital form at the back of this brochure.



Feel free to ask any other general questions to
OFFICE@BSLM.ORG.UK



PROMO SYMPOSIUM PACKAGES

ORGANISATIONAL PRICING STRUCTURE:



	SILVER PACKAGE	GOLD PACKAGE	PLATINUM PACKAGE
	£ 400	£ 500	£ 650
ROOM SIZE			
250 CAPACITY* 1HR SESSION			✓
140 CAPACITY* 1HR SESSION		✓	
100 CAPACITY* 45MIN SESSION	✓		
MARKETING			
CROWDCOMMS APP NOTIFICATION TO ALL DELEGATES AT BSLM26			✓
FEATURED IN 'PLAN YOUR SCHEDULE' STATIC POST ON BSLM SOCIAL MEDIA	✓	✓	INDIVIDUAL SYMPOSIUM REEL AND STATIC POST FEATURED ON BSLM SOCIAL MEDIA**
EVENT FEATURE IN 'PLAN YOUR SCHEDULE' PRE EVENT DELEGATE PROMO MAIL	✓	✓	✓
BSLM SOCIAL MEDIA STORY REMINDER OF EVENT	✓	✓	✓
SHORT VIDEO COVERAGE DURING EVENT ON BSLM SOCIAL MEDIA***		✓	✓
POST SYMPOSIUM PROMO DELEGATE MAIL	✓	✓	✓

*THIS IS MAXIMUM CAPACITY OF THE ROOM - BSLM CANNOT GUARANTEE ATTENDEE NUMBERS IN ANY SESSIONS.

** THESE TWO POSTS CAN BE FEATURED EITHER BEFORE OR AFTER THE SYMPOSIUM, HOWEVER YOU CHOOSE.

***LENGTH OF SHORT VIDEO COVERAGE DEPENDENT ON TIER.

THE DETAILS

OUR PACKAGE RATES REFLECT A COMBINATION OF THE ROOM CAPACITY, OPTIONS FOR EXTENDED TALK TIME AND NETWORKING OPPORTUNITIES ALONGSIDE THE ADDED MARKETING SPECIFIC FOR YOU AND YOUR SYMPOSIUM.

IF YOU DO ENQUIRE AROUND OUR PACKAGES, OUR RELATIONSHIP MANAGER WILL BE IN TOUCH DIRECTLY TO DISCUSS THE BENEFITS OF YOUR OPTIONS IN MORE DETAIL AND ANSWER ANY QUERIES YOU MAY HAVE. IT'S IMPORTANT TO US WE ARE ABLE TO PROVIDE YOU WITH AN INDIVIDUALISED, TAILORED EXPERIENCE FOR BSLM 2026.



PROMO SYMPOSIUM PACKAGES

CHARITY PRICING STRUCTURE:



ROOM SIZE

BRONZE PACKAGE

£ 275

SILVER PACKAGE

£ 300

GOLD PACKAGE

£ 350

140 CAPACITY*
1HR SESSION



100 CAPACITY*
45MIN SESSION



WITH LIMITED AVAILABILITY



MARKETING

FEATURED IN 'PLAN
YOUR SCHEDULE'
STATIC POST ON BSLM
SOCIAL MEDIA



SYMPOSIUM FEATURE IN
'PLAN YOUR SCHEDULE'
PRE SYMPOSIUM
DELEGATE PROMO MAIL

OPTION OF 1
PROMO MAIL
EITHER
PRE OR POST



BSLM SOCIAL
MEDIA STORY
REMINDER OF
SYMPOSIUM



SHORT VIDEO
COVERAGE DURING
SYMPOSIUM ON BSLM
SOCIAL MEDIA**



POST
SYMPOSIUM
PROMO
DELEGATE MAIL

OPTION OF 1
PROMO MAIL
EITHER
PRE OR POST



*THIS IS MAXIMUM CAPACITY OF THE ROOM - BSLM CANNOT GUARANTEE ATTENDEE NUMBERS IN ANY SESSIONS

** LENGTH OF SHORT VIDEO COVERAGE DEPENDENT ON TIER.

THE DETAILS

WE WANT TO MAKE SURE THAT OUR PACKAGE RATES ARE AVAILABLE FOR CHARITIES TO BENEFIT FROM THE BSLM CONFERENCE EXPERIENCE. THESE RATES REFLECT A COMBINATION OF THE ROOM CAPACITY, OPTIONS FOR EXTENDED TALK TIME AND NETWORKING OPPORTUNITIES ALONGSIDE THE ADDED MARKETING SPECIFIC FOR YOU AND YOUR SYMPOSIUM.

IF YOU DO ENQUIRE AROUND OUR PACKAGES, OUR RELATIONSHIP MANAGER WILL BE IN TOUCH DIRECTLY TO DISCUSS THE BENEFITS OF YOUR OPTIONS IN MORE DETAIL AND ANSWER ANY QUERIES YOU MAY HAVE. IT'S IMPORTANT TO US WE ARE ABLE TO PROVIDE YOU WITH AN INDIVIDUALISED, TAILORED EXPERIENCE FOR BSLM 2026.



YOUR APPLICATION

SUPPORTED
BY



For the application process we have a **digital form**, accessible below, for your application details.

Please do complete this to the best of your ability.

If you have any queries while completing the form, or regarding any terms and conditions, do contact us.

BSLM 2026 SPONSORSHIP AND EXHIBITOR BOOKING FORM



SCAN FOR ACCESS

CAN'T ACCESS VIA
THE QR CODE?



[CLICK HERE FOR
THE FORM](#)



QUERIES ABOUT ACCESSING? GIVE US AN EMAIL!
OFFICE@BSLM.ORG.UK